

WSB5511M
3A Schottky Barrier Diode
[Http://www.sh-willsemi.com](http://www.sh-willsemi.com)
Features

- Low forward voltage
- Extremely low thermal resistance
- High current capability

SMA (DO-214AC)

Circuit

Marking
Applications

- Switching circuit
- Middle current rectification

Absolute maximum ratings

Parameter	Symbol	Value	Unit
Reverse voltage (repetitive peak)	V_{RRM}	40	V
Reverse voltage (DC)	V_R	40	V
Average rectified forward current (DC)	I_O	3.0	A
Forward Peak Surge Current ⁽¹⁾	I_{FSM}	50	A
Junction temperature	T_J	-55 ~ 150	°C
Operating temperature	T_{opr}	-55 ~ 150	°C
Storage temperature	T_{stg}	-55 ~ 150	°C

Electronics characteristics ($T_A=25^\circ\text{C}$)

Parameter	Symbol	Condition	Min.	Typ.	Max.	Unit
Forward voltage ⁽²⁾	V_F	$I_F=3.0\text{A}$			0.50	V
Reverse current	I_R	$V_R=40\text{V}$			0.5	mA
Junction capacitance	C_J	$V_R=4\text{V}, F=1\text{MHz}$		220		pF
Thermal resistance	$R_{\theta(J-L)}$	Junction to Lead (Fig.2)		17		K/W

Order Informations

Device	Package	Marking	Shipping
WSB5511M-2/TR	SMA (DO-214AC)	.EC* ⁽³⁾	5000/Reel&Tape

Note1: Pulse width=8.3ms, single pulse;
Note2: Single Pulse, test $T_p=380\mu\text{s}$;
Note3: * =Month code (A~Z); .EC =Device code;

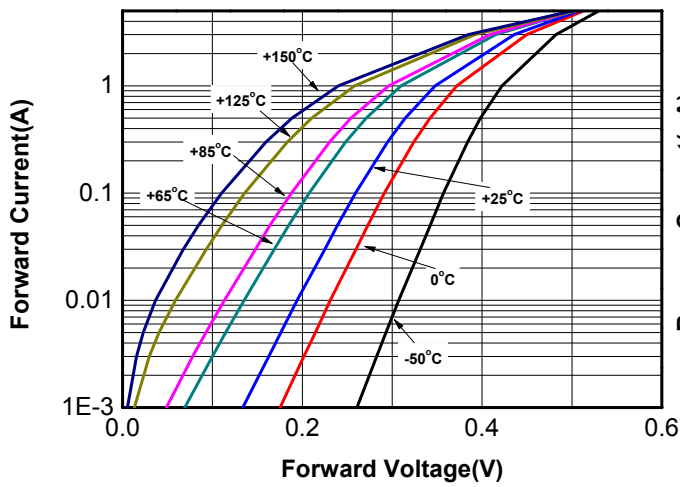
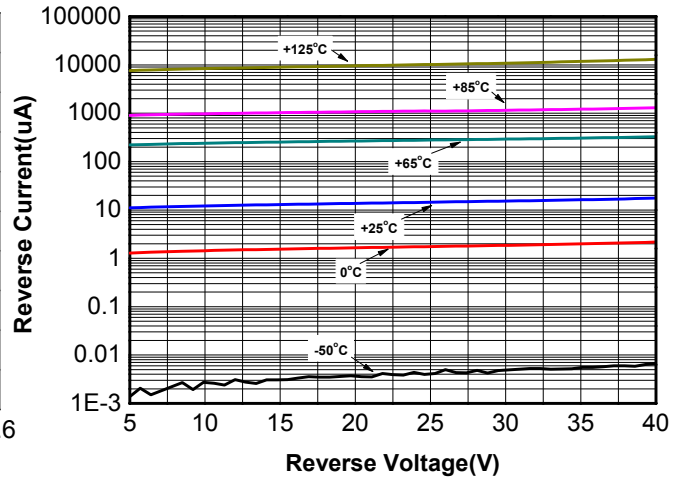
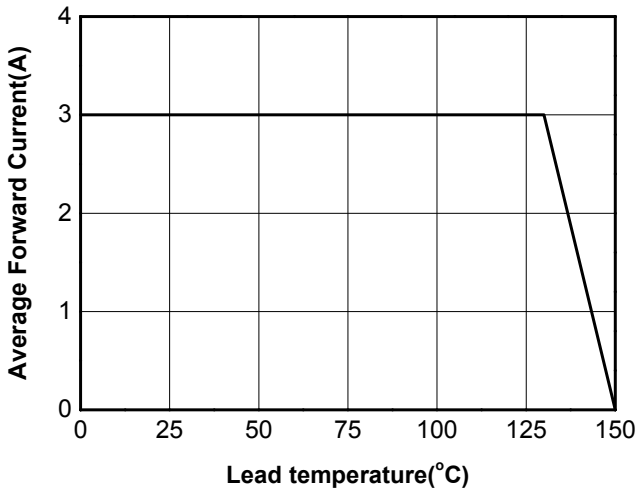
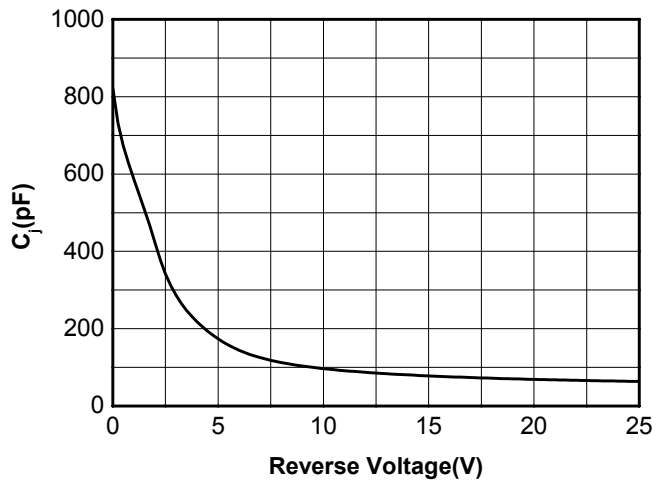
Typical characteristics (Ta=25°C, unless otherwise noted)

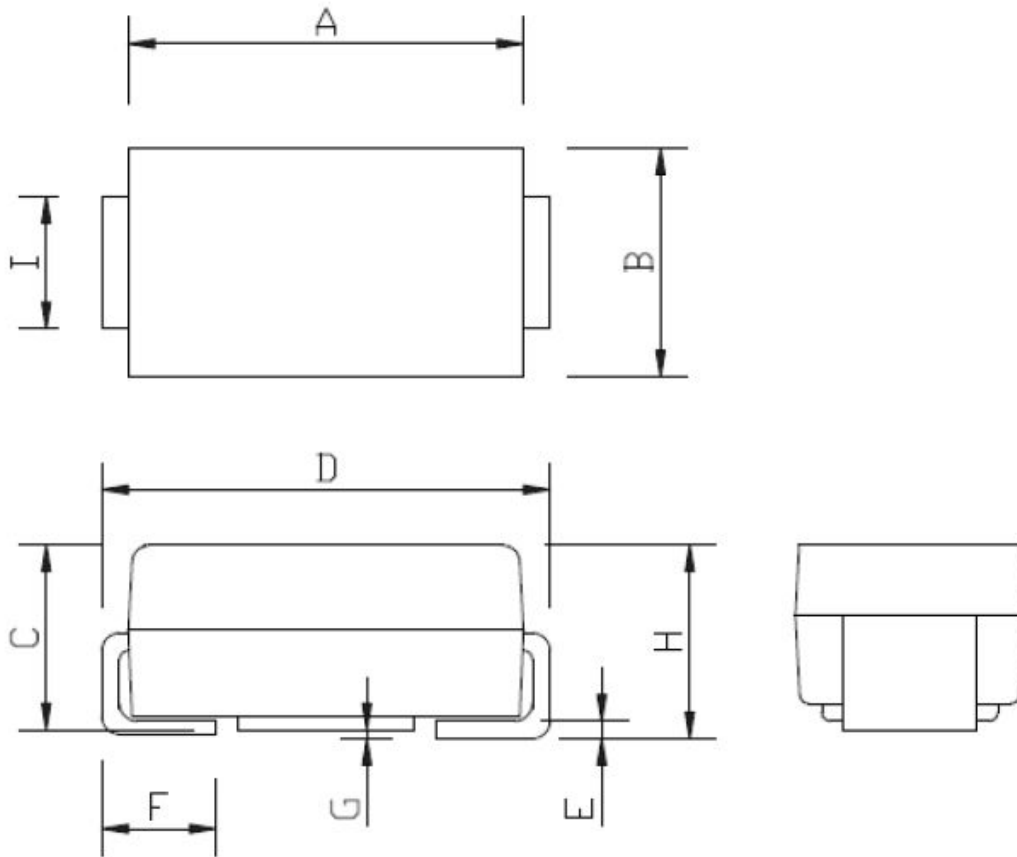
Fig.1 Forward voltage vs. Forward current

Fig.2 Reverse current vs. Reverse voltage

Fig.3 Maximum Forward Current Derating Curve

Fig.4 Junction capacitance vs. Reverse voltage

Package outline dimensions
SMA (DO-214AC)

Symbol	Dimensions in millimeter	
	Min.	Max.
A	4.25	4.65
B	2.40	2.80
C	1.85	2.15
D	4.85	5.35
E	0.10	0.30
F	0.90	1.50
G	0.20 Max.	
H	1.90	2.30
I	1.35	1.65